

Soils Map

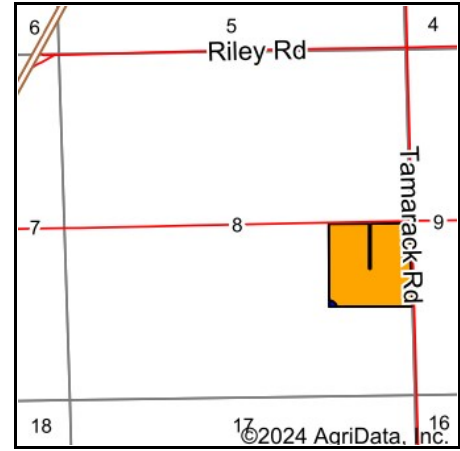

State: **Indiana**
 County: **St. Joseph**
 Location: **8-35N-1E**
 Township: **Lincoln**
 Acres: **35.84**
 Date: **12/23/2024**

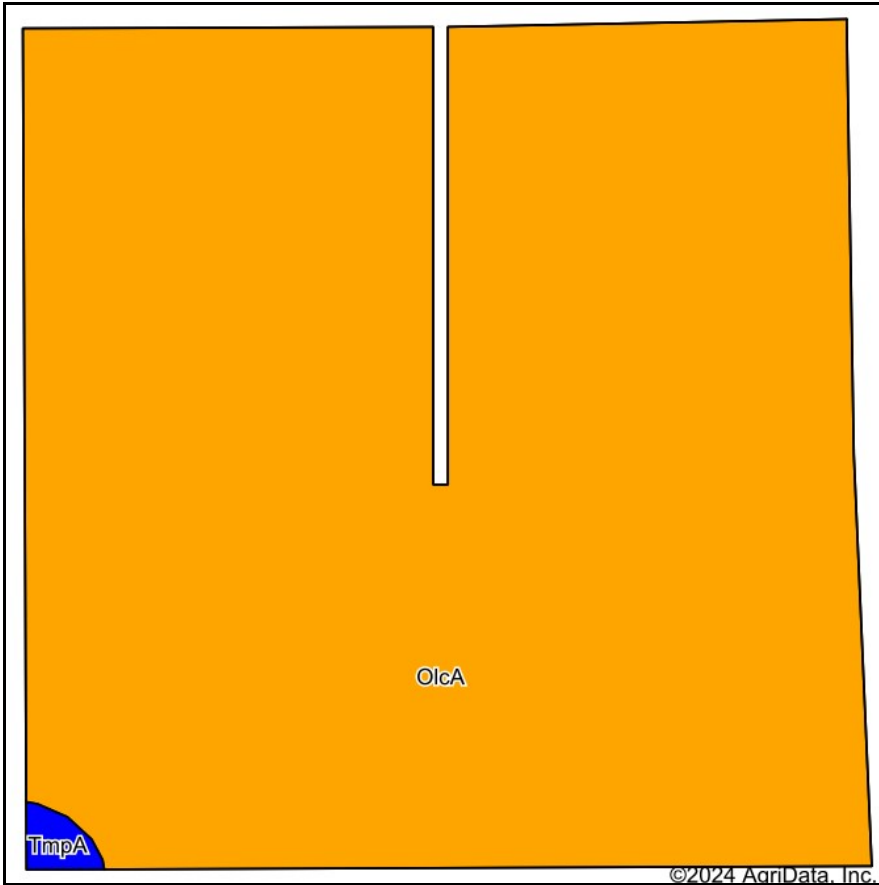

Maps Provided By:



Soils data provided by USDA and NRCS.

Archived Soils Ending 11/27/2017 Area Symbol: IN141, Soil Area Version: 20

Code	Soil Description	Acres	Percent of field	Non-Irr Class Legend	Non-Irr Class *c	Corn Bu	Corn Irrigated Bu	Soybeans Bu	Soybeans Irrigated Bu	NCCPI Corn and Soybeans
OlcA	Oshtemo sandy loam, 0 to 1 percent slopes	35.65	99.5%		lls	109	12	38	4	67
TmpA	Tracy sandy loam, 0 to 1 percent slopes	0.19	0.5%		lls	102		36		56
Weighted Average					2.99	109	11.9	38	4	66.9

*c: Using Capabilities Class Dominant Condition Aggregation Method