

Soils Map

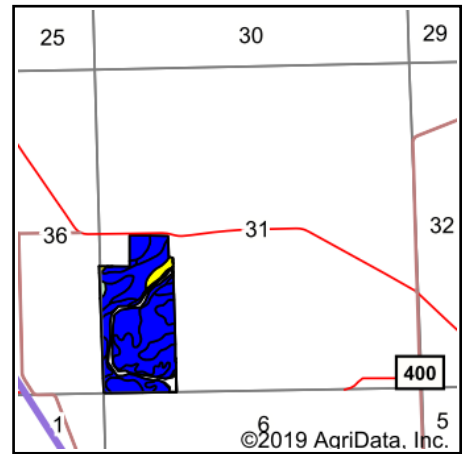

State: **Indiana**
 County: **Delaware**
 Location: **31-20N-11E**
 Township: **Perry**
 Acres: **60.73**
 Date: **9/3/2019**

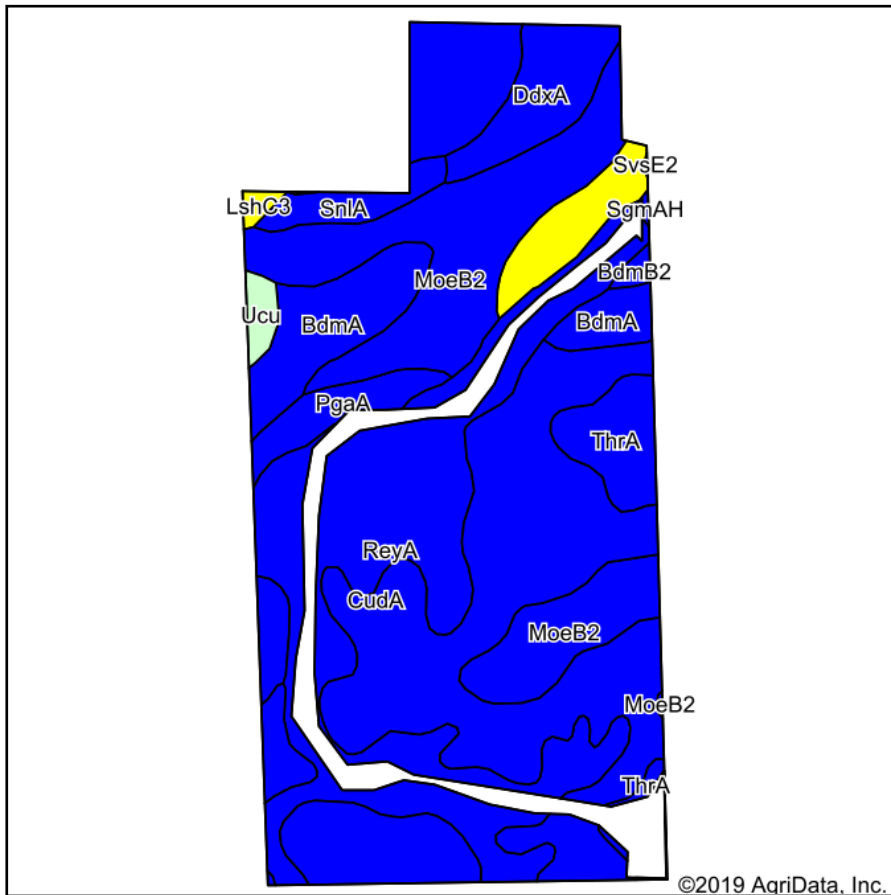

Soils data provided by USDA and NRCS.

| Area Symbol: IN035. Soil Area Version: 23 | | | | | | | | | | | | |
|---|---|-------|------------------|----------------------|-------------|---|------------------------------|------------------|------|----------|--------------|-------------------|
| Code | Soil Description | Acres | Percent of field | Non-Irr Class Legend | Water Table | Restrictive Layer | Soil Drainage | Non-Irr Class *c | Corn | Soybeans | Winter wheat | *n NCCPI Soybeans |
| CudA | Crosby silt loam, 0 to 2 percent slopes | 19.66 | 32.4% | | 0.5ft. | 3ft. (Densic material) | Somewhat poorly drained | llw | 143 | 47 | 64 | 51 |
| ReyA | Rensselaer loam, 0 to 1 percent slopes | 13.27 | 21.9% | | 0ft. | > 6.5ft. | Poorly drained | llw | 173 | 49 | 67 | 94 |
| MoeB2 | Miamian silt loam, New Castle Till Plain, 2 to 6 percent slopes, eroded | 13.08 | 21.5% | | 2.5ft. | 2.7ft. (Densic material) | Well drained | lle | 127 | 45 | 57 | 30 |
| BdmA | Belmore silt loam, 0 to 1 percent slopes | 4.06 | 6.7% | | > 6.5ft. | > 6.5ft. | Well drained | lls | 146 | 51 | 72 | 57 |
| DdxA | Digby-Haney silt loams, 0 to 1 percent slopes | 2.54 | 4.2% | | 1.5ft. | > 6.5ft. | Somewhat poorly drained | llw | 151 | 51 | 68 | 67 |
| ThrA | Treaty silty clay loam, 0 to 1 percent slopes | 2.15 | 3.5% | | 4.5ft. | > 6.5ft. | Poorly drained | llw | 173 | 51 | 69 | 76 |
| PgaA | Pella silty clay loam, 0 to 1 percent slopes | 2.11 | 3.5% | | 0ft. | > 6.5ft. | Poorly drained | llw | 173 | 49 | 69 | 96 |
| CdgC3 | Casco sandy clay loam, 6 to 15 percent slopes, severely eroded | 1.86 | 3.1% | | > 6.5ft. | 1.3ft. (Strongly contrasting textural stratification) | Somewhat excessively drained | IVe | 109 | 37 | 45 | 28 |
| SnIA | Southwest silt loam, 0 to 1 percent slopes | 1.10 | 1.8% | | 0.5ft. | > 6.5ft. | Poorly drained | llw | 163 | 48 | 59 | 93 |
| Ucu | Udorthents, loamy-skeletal | 0.48 | 0.8% | | > 6.5ft. | > 6.5ft. | Excessively drained | | 96 | 34 | 43 | 0 |
| BdmB2 | Belmore silt loam, 1 to 5 percent slopes, eroded | 0.21 | 0.3% | | > 6.5ft. | > 6.5ft. | Well drained | lle | 141 | 49 | 69 | 46 |
| LshC3 | Losantville clay loam, 6 to 12 percent slopes, severely eroded | 0.21 | 0.3% | | 1.5ft. | 1.3ft. (Densic material) | Moderately well drained | IVe | 111 | 38 | 49 | 13 |

Maps Provided By:



© AgriData, Inc. 2019

www.AgriDataInc.com

| | | | | | |
|--|-------------------------|--------------|-------------|-------------|----------------|
| | Weighted Average | 147.6 | 47.2 | 63.3 | *n 58.9 |
|--|-------------------------|--------------|-------------|-------------|----------------|

*n: The aggregation method is "Weighted Average using major components"

*c: Using Capabilities Class Dominant Condition Aggregation Method

Soils data provided by USDA and NRCS.

Soils Map

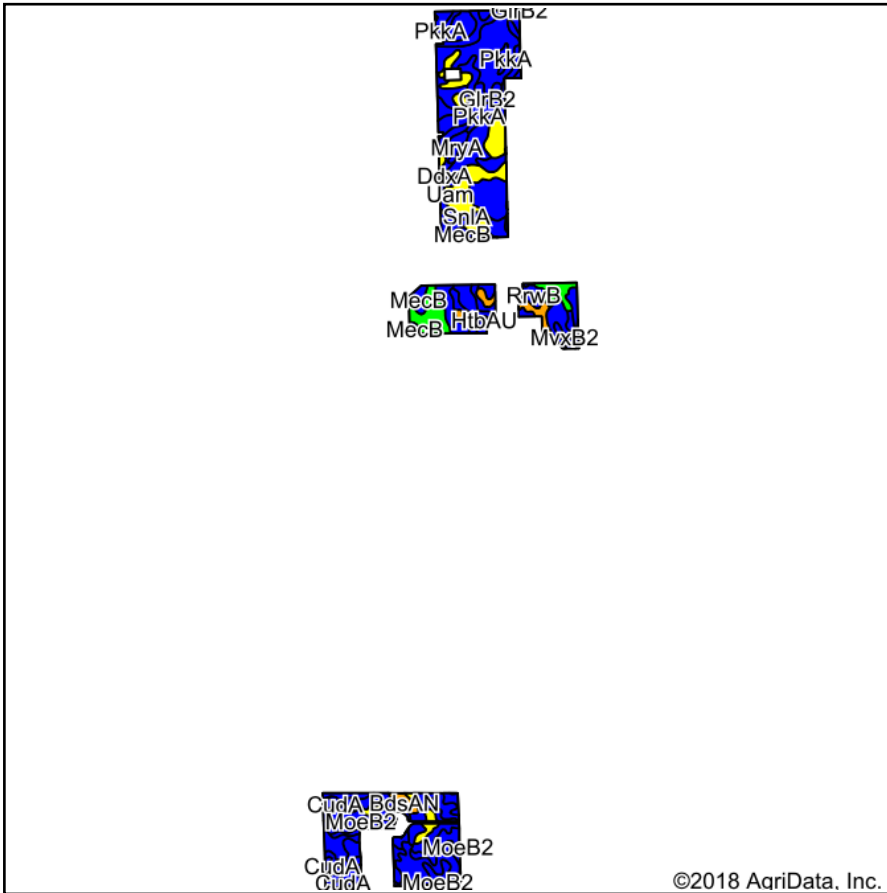

Soils data provided by USDA and NRCS.

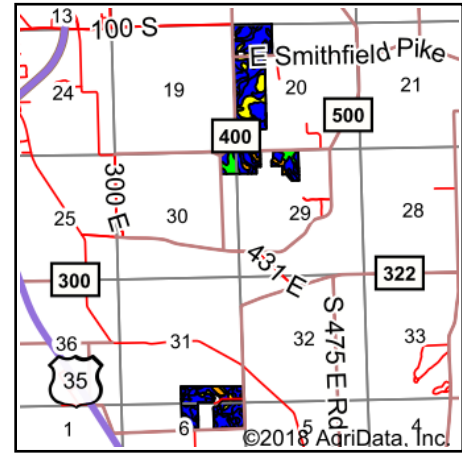

State: **Indiana**
 County: **Delaware**
 Location: **29-20N-11E**
 Township: **Liberty**
 Acres: **292.72**
 Date: **10/4/2018**



Area Symbol: IN035, Soil Area Version: 22

| Code | Soil Description | Acres | Percent of field | Non-Irr Class Legend | Soil Drainage | Non-Irr Class *c | Corn | Soybeans |
|-------|---|-------|------------------|----------------------|-------------------------|------------------|------|----------|
| BleA | Blount silt loam, end moraine, 0 to 2 percent slopes | 38.06 | 13.0% | | Somewhat poorly drained | Ilw | 140 | 45 |
| CudA | Crosby silt loam, 0 to 2 percent slopes | 34.92 | 11.9% | | Somewhat poorly drained | Ilw | 143 | 47 |
| ThrA | Treaty silty clay loam, 0 to 1 percent slopes | 31.41 | 10.7% | | Poorly drained | Ilw | 173 | 51 |
| FgrC3 | Fox-Muncie clay loams, 6 to 12 percent slopes, severely eroded | 27.30 | 9.3% | | Well drained | IVe | 95 | 33 |
| Pkka | Pewamo silty clay loam, 0 to 1 percent slopes | 20.23 | 6.9% | | Very poorly drained | Ilw | 157 | 47 |
| MoeB2 | Miamian silt loam, New Castle Till Plain, 2 to 6 percent slopes, eroded | 18.42 | 6.3% | | Well drained | Ile | 127 | 45 |
| GlrB2 | Glynwood silt loam, 1 to 4 percent slopes, eroded | 13.72 | 4.7% | | Moderately well drained | Ile | 129 | 44 |
| BdmB2 | Belmore silt loam, 1 to 5 percent slopes, eroded | 12.49 | 4.3% | | Well drained | Ile | 141 | 49 |
| MecB | Martinsville loam, 2 to 6 percent slopes | 12.29 | 4.2% | | Well drained | Ile | 145 | 51 |
| FgoB2 | Fox-Muncie complex, 2 to 6 percent slopes, eroded | 10.60 | 3.6% | | Well drained | Ile | 114 | 40 |
| MecA | Martinsville loam, 0 to 2 percent slopes | 10.02 | 3.4% | | Well drained | Is | 146 | 51 |
| MphA | Milford silty clay loam, stratified sandy substratum, 0 to 1 percent slopes | 8.84 | 3.0% | | Very poorly drained | Ilw | 160 | 44 |
| MryA | Millgrove silty clay loam, 0 to 1 percent slopes | 8.23 | 2.8% | | Very poorly drained | Ilw | 171 | 49 |
| DdxA | Digby-Haney silt loams, 0 to 1 percent slopes | 7.72 | 2.6% | | Somewhat poorly drained | Ilw | 151 | 51 |
| BdlC2 | Belmore loam, 6 to 12 percent slopes, eroded | 7.06 | 2.4% | | Well drained | IIIe | 130 | 46 |
| SniA | Southwest silt loam, 0 to 1 percent slopes | 6.29 | 2.1% | | Poorly drained | Ilw | 163 | 48 |
| MvxA | Mountpleasant silt loam, 0 to 2 percent slopes | 5.53 | 1.9% | | Well drained | Is | 130 | 46 |
| LshC3 | Losantville clay loam, 6 to 12 percent slopes, severely eroded | 5.00 | 1.7% | | Moderately well drained | IVe | 111 | 38 |
| MvxB2 | Mountpleasant silt loam, 2 to 6 percent slopes, eroded | 4.50 | 1.5% | | Well drained | Ile | 126 | 44 |



| | | | | | | | | | |
|-------------------------|--|------|------|--|-------------------------|------|-----|--------------|-------------|
| RrwB | Rawson loam, 1 to 5 percent slopes | 3.11 | 1.1% | | Moderately well drained | Ile | 142 | 50 | |
| BdsAN | Benadum silt loam, drained, 0 to 1 percent slopes | 3.01 | 1.0% | | Very poorly drained | IIIw | 156 | 46 | |
| MumD2 | Morley silt loam, 10 to 15 percent slopes, eroded | 1.04 | 0.4% | | Moderately well drained | IVe | 101 | 35 | |
| MorA | Milford mucky silty clay, pothole, 0 to 1 percent slopes | 1.02 | 0.3% | | Very poorly drained | IVw | 87 | 24 | |
| Uam | Udorthents, loamy | 0.87 | 0.3% | | Moderately well drained | | 126 | 44 | |
| EdxD2 | Eldean silt loam, 12 to 18 percent slopes, eroded | 0.65 | 0.2% | | Well drained | IVe | 84 | 29 | |
| HtbAU | Houghton muck, undrained, 0 to 1 percent slopes | 0.39 | 0.1% | | Very poorly drained | Vw | 8 | 2 | |
| Weighted Average | | | | | | | | 139.7 | 45.4 |

*c: Using Capabilities Class Dominant Condition Aggregation Method

Soils data provided by USDA and NRCS.