

Soils Map

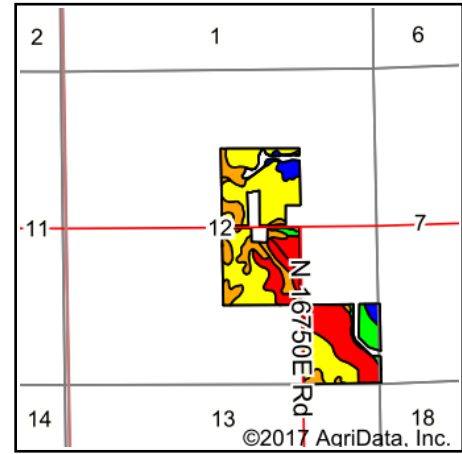

State: **Illinois**
 County: **Kankakee**
 Location: **12-32N-14E**
 Township: **Yellowhead**
 Acres: **108.67**
 Date: **11/27/2017**

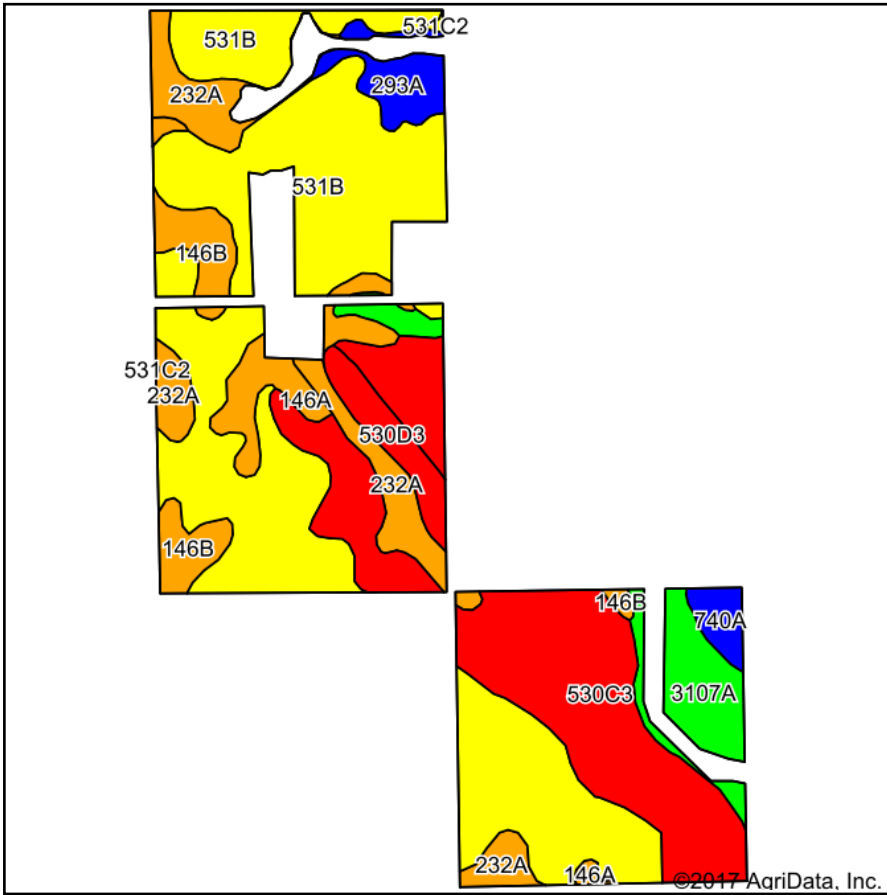

Soils data provided by USDA and NRCS.

Area Symbol: IL091, Soil Area Version: 12

Code	Soil Description	Acres	Percent of field	Il. State Productivity Index Legend	Subsoil rooting a	Corn Bu/A	Soybeans Bu/A	Wheat Bu/A	Oats Bu/A	Sorghum c Bu/A	Alfalfa d hay, T/A	Grass-le gume e hay, T/A	Crop productivity index for optimum management
**531B	Markham silt loam, 2 to 4 percent slopes	49.44	45.5%	Yellow	FAV	**153	**50	**60	**78	0	**4.10	0.00	**113
**530C3	Ozaukee silty clay loam, 4 to 6 percent slopes, severely eroded	26.06	24.0%	Red	FAV	**132	**41	**53	**70	0	**3.31	0.00	**96
232A	Ashkum silty clay loam, 0 to 2 percent slopes	9.33	8.6%	Orange	FAV	170	56	65	85	0	0.00	5.14	127
3107A	Sawmill silty clay loam, heavy till plain, 0 to 2 percent slopes, frequently flooded	6.64	6.1%	Green	FAV	189	60	71	98	0	0.00	5.77	139
**146B	Elliott silt loam, 2 to 4 percent slopes	5.08	4.7%	Orange	FAV	**166	**54	**67	**86	0	0.00	**4.97	**124
146A	Elliott silt loam, 0 to 2 percent slopes	4.47	4.1%	Orange	FAV	168	55	68	87	0	0.00	5.02	125
293A	Andres silt loam, 0 to 2 percent slopes	3.03	2.8%	Blue	FAV	184	59	71	97	0	0.00	5.39	135
**530D3	Ozaukee silty clay loam, 6 to 12 percent slopes, severely eroded	3.02	2.8%	Red	FAV	**129	**40	**52	**69	0	**3.23	0.00	**94
740A	Darroch silt loam, 0 to 2 percent slopes	1.50	1.4%	Blue	FAV	177	57	70	92	0	0.00	5.14	129
**531C2	Markham silt loam, 4 to 6 percent slopes, eroded	0.10	0.1%	Yellow	FAV	**147	**48	**58	**75	0	**3.93	0.00	**108
Weighted Average						153.4	49.4	60.3	79.1	*	2.75	1.45	113

Table: Optimum Crop Productivity Ratings for Illinois Soil by K.R. Olson and J.M. Lang, Office of Research, ACES, University of Illinois at Champaign-Urbana. Version: 1/2/2012 Amended Table S2 B811

Crop yields and productivity indices for optimum management (B811) are maintained at the following NRES web site:

<https://www.ideals.illinois.edu/handle/2142/1027/>

** Indexes adjusted for slope and erosion according to Bulletin 811 Table S3

a UNF = unfavorable; FAV = favorable

b Soils in the southern region were not rated for oats and are shown with a zero "0".

c Soils in the northern region or in both regions were not rated for grain sorghum and are shown with a zero "0".

d Soils in the poorly drained group were not rated for alfalfa and are shown with a zero "0".

e Soils in the well drained group were not rated for grass-legume and are shown with a zero "0".

*c: Using Capabilities Class Dominant Condition Aggregation Method

Soils data provided by USDA and NRCS. Soils data provided by University of Illinois at Champaign-Urbana.

Soils Map

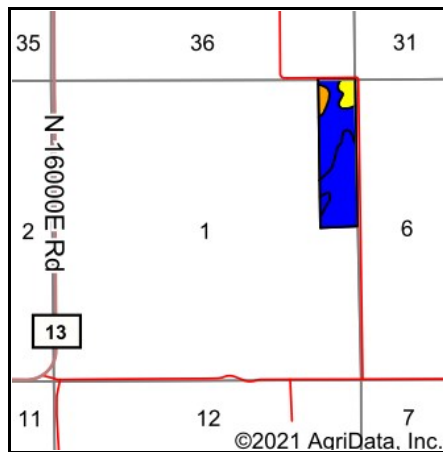
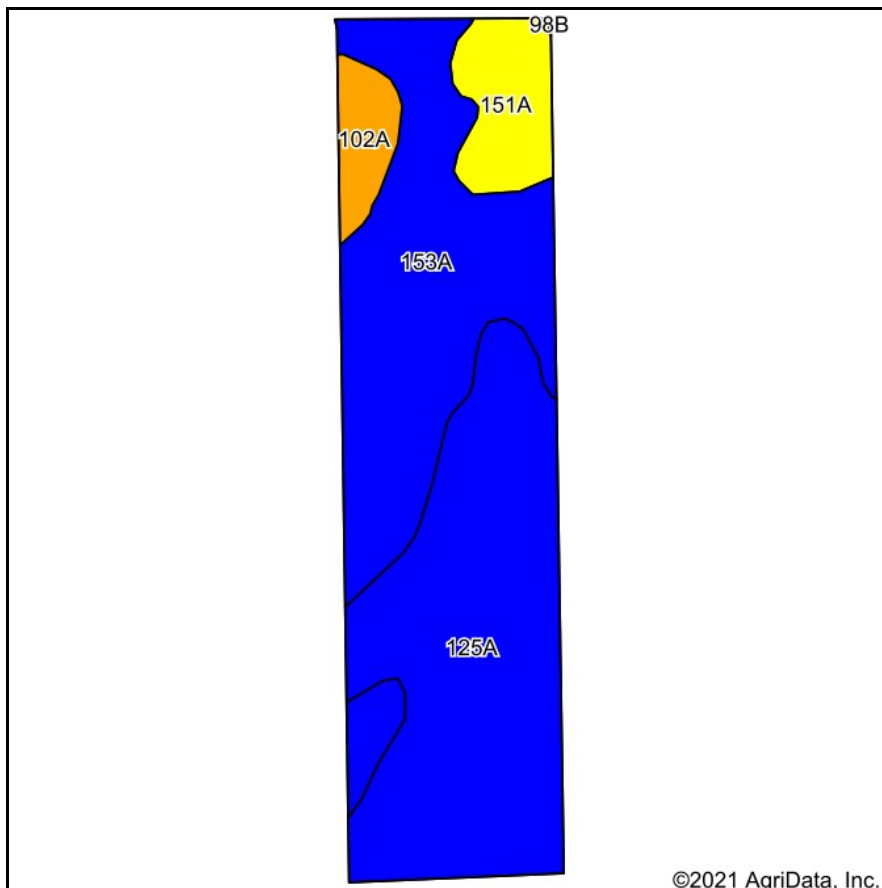

State: **Illinois**
 County: **Kankakee**
 Location: **1-31N-14E**
 Township: **Momence**
 Acres: **39.75**
 Date: **8/12/2021**



Soils data provided by USDA and NRCS.

©2021 AgriData, Inc.

© AgriData, Inc. 2021

www.AgriDataInc.com

Area Symbol: IL091, Soil Area Version: 17

Code	Soil Description	Acres	Percent of field	Il. State Productivity Index Legend	Water Table	Restrictive Layer	Soil Drainage	Subsoil rooting ^a	Corn Bu/A	Soybeans Bu/A	Wheat Bu/A	Grass-legume hay, T/A	Crop productivity index for optimum management
125A	Selma loam, 0 to 2 percent slopes	18.82	47.3%		0.5ft.	> 6.5ft.	Poorly drained	FAV	176	57	70	6.38	129
153A	Pella silty clay loam, 0 to 2 percent slopes	15.79	39.7%		0.5ft.	> 6.5ft.	Poorly drained	FAV	183	60	70	5.27	136
151A	Ridgeville fine sandy loam, 0 to 2 percent slopes	3.33	8.4%		1.5ft.	> 6.5ft.	Somewhat poorly drained	FAV	151	51	63	5.02	114
102A	La Hogue loam, 0 to 2 percent slopes	1.81	4.6%		1.5ft.	> 6.5ft.	Somewhat poorly drained	FAV	162	52	71	5.27	121
Weighted Average									176	57.5	69.5	5.77	130.2

Table: Optimum Crop Productivity Ratings for Illinois Soil by K.R. Olson and J.M. Lang, Office of Research, ACES, University of Illinois at Champaign-Urbana. Version: 1/2/2012 Amended Table S2 B811

Crop yields and productivity indices for optimum management (B811) are maintained at the following NRES web site:

<http://soilproductivity.nres.illinois.edu/>

** Indexes adjusted for slope and erosion according to Bulletin 811 Table S3

^a UNF = unfavorable; FAV = favorable

^e Soils in the well drained group were not rated for grass-legume and are shown with a zero "0".

Soils Map

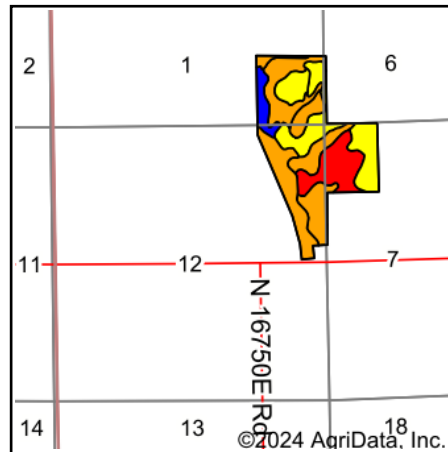
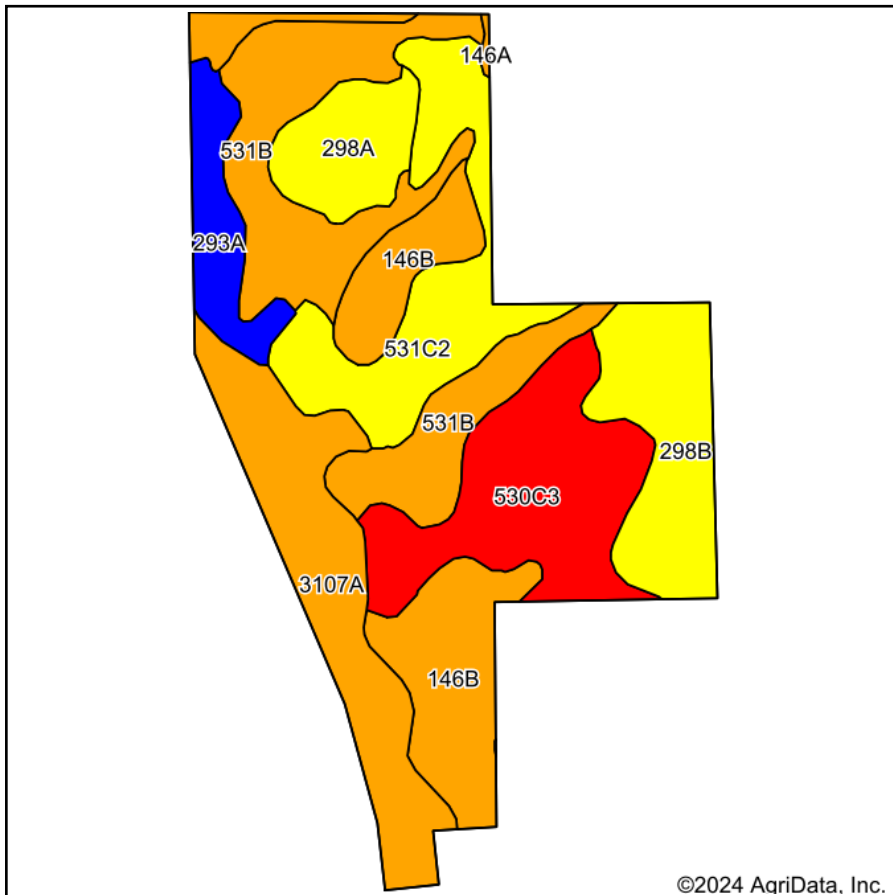

State: **Illinois**
 County: **Kankakee**
 Location: **12-32N-14E**
 Township: **Yellowhead**
 Acres: **123.34**
 Date: **1/16/2024**



Soils data provided by USDA and NRCS.

©2024 AgriData, Inc.

© AgriData, Inc. 2023 www.AgriDataInc.com

Area Symbol: IL091, Soil Area Version: 20

Code	Soil Description	Acres	Percent of field	Il. State Productivity Index Legend	Subsoil rooting ^a	Corn Bu/A	Soybeans Bu/A	Wheat Bu/A	Oats Bu/A ^b	Sorghum ^c Bu/A	Grass-le gume ^e hay, T/A	Crop productivity index for optimum management	*n NCCPI Corn	*n NCCPI Soybeans
**531B	Markham silt loam, 2 to 4 percent slopes	23.92	19.4%		FAV	**161	**51	**63	**83	0	**4.70	**119	64	55
**3107A	Sawmill silty clay loam, heavy till plain, 0 to 2 percent slopes, frequently flooded	20.42	16.6%		FAV	**170	**54	**64	**88	**1	**5.20	**125	61	45
**530C3	Ozaukee silty clay loam, 4 to 6 percent slopes, severely eroded	19.06	15.5%		FAV	**130	**41	**51	**69	0	**3.30	**94	46	36
**146B	Elliott silt loam, 2 to 4 percent slopes	16.94	13.7%		FAV	**166	**54	**67	**86	0	**5.00	**124	63	59

Soils data provided by USDA and NRCS. Soils data provided by University of Illinois at Champaign-Urbana.



Code	Soil Description	Acres	Percent of field	Il. State Productivity Index Legend	Subsoil rooting a	Corn Bu/A	Soybeans Bu/A	Wheat Bu/A	Oats Bu/A b	Sorghum c Bu/A	Grass-legume e hay, T/A	Crop productivity index for optimum management	*n NCCPI Corn	*n NCCPI Soybeans
**531C2	Markham silt loam, 4 to 6 percent slopes, eroded	16.10	13.1%		FAV	**153	**49	**60	**79	0	**4.40	**113	57	44
**298B	Beecher silt loam, 2 to 4 percent slopes	13.06	10.6%		FAV	**150	**50	**60	**78	0	**4.60	**113	66	60
298A	Beecher silt loam, 0 to 2 percent slopes	7.33	5.9%		FAV	152	51	61	79	0	4.60	114	67	60
293A	Andres silt loam, 0 to 2 percent slopes	6.32	5.1%		FAV	184	59	71	97	0	5.40	135	71	70
146A	Elliott silt loam, 0 to 2 percent slopes	0.19	0.2%		FAV	168	55	68	87	0	5.00	125	63	61
Weighted Average						156.8	50.4	61.5	81.5	0.2	4.6	115.9	*n 60.4	*n 51.1

Table: Optimum Crop Productivity Ratings for Illinois Soil EFOTG are sourced from Bulletin 811 calculated Map Unit Base Yield Indices, and adjusted (Adj) for slope, erosion, flooding, and surface texture. Publication Date: 02-08-2023

Crop yields and productivity (B811 EFOTG) are maintained at the following USDA web site: 2023 Illinois Soil Productivity and Yield Indices: <https://efotg.sc.egov.usda.gov/#/state/IL/documents/section=2&folder=52809>

** Base indexes from Bulletin 811 adjusted for slope, erosion, flooding, and surface texture according to the Il. Soils EFOTG

b Soils in the southern region were not rated for oats and are shown with a zero "0".

c Soils in the northern region or in both regions were not rated for grain sorghum and are shown with a zero "0".

e Soils in the well drained group were not rated for grass-legume and are shown with a zero "0".

*n: The aggregation method is "Weighted Average using all components"

Soils Map

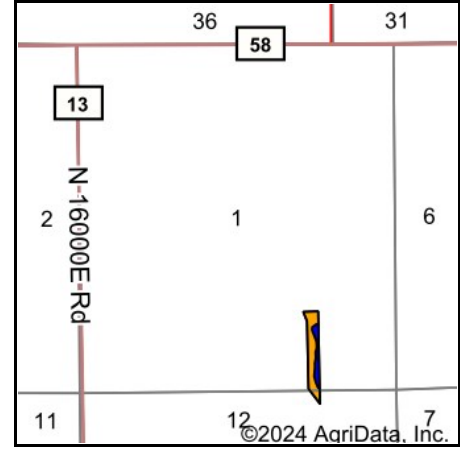
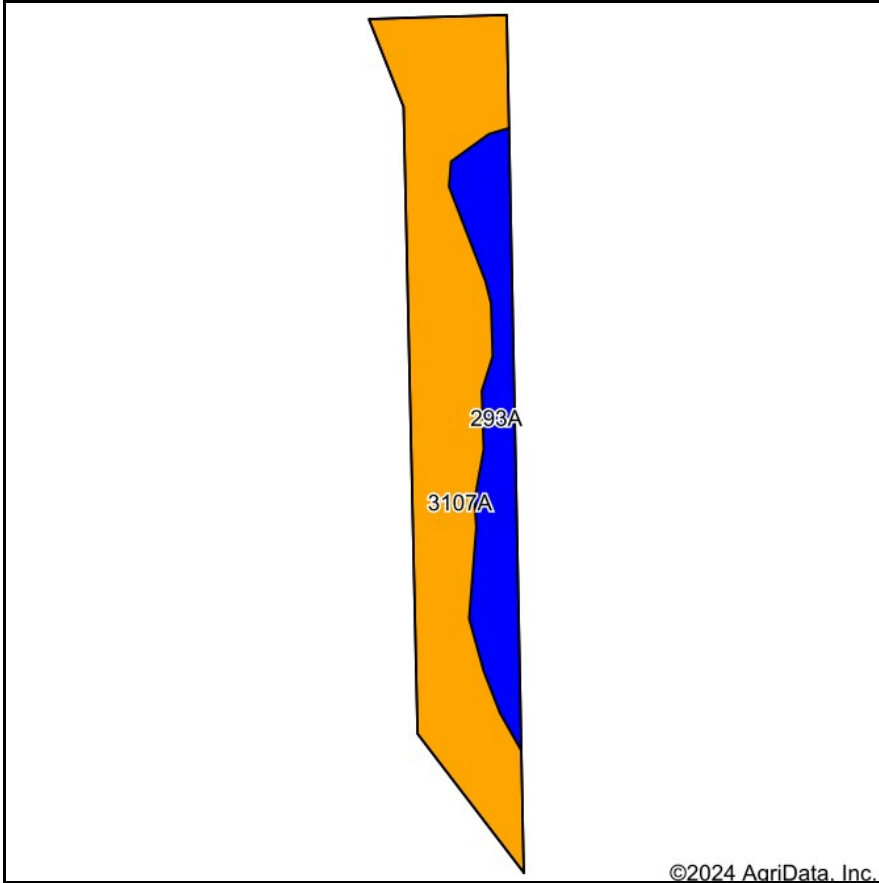

State: **Illinois**
 County: **Kankakee**
 Location: **1-32N-14E**
 Township: **Yellowhead**
 Acres: **6.22**
 Date: **3/13/2024**



Maps Provided By:



Area Symbol: IL091, Soil Area Version: 20

Code	Soil Description	Acres	Percent of field	Il. State Productivity Index Legend	Subsoil rooting ^a	Corn Bu/A	Soybeans Bu/A	Wheat Bu/A	Oats Bu/A ^b	Sorghum ^c Bu/A	Grass-legume ^e hay, T/A	Crop productivity index for optimum management	*n NCCPI Corn	*n NCCPI Soybeans
**3107A	Sawmill silty clay loam, heavy till plain, 0 to 2 percent slopes, frequently flooded	4.56	73.3%		FAV	**170	**54	**64	**88	**1	**5.20	**125	61	45
293A	Andres silt loam, 0 to 2 percent slopes	1.66	26.7%		FAV	184	59	71	97	0	5.40	135	71	70
Weighted Average						173.7	55.3	65.9	90.4	0.7	5.3	127.7	*n 63.7	*n 51.7

Soils data provided by USDA and NRCS. Soil data provided by University of Illinois at Champaign-Urbana. **Table: Optimum Crop Productivity Ratings for Illinois Soils EFOTG are sourced from Bulletin 811 calculated Map Unit Base Yield Indices, and adjusted (Adj) for slope, erosion, flooding, and surface texture.** Publication Date: 02-08-2023
 Crop yields and productivity (B811 EFOTG) are maintained at the following USDA web site: 2023 Illinois Soil Productivity and Yield Indices: <https://efotg.sc.egov.usda.gov/#/state/IL/documents/section=2&folder=52809>

** Base indexes from Bulletin 811 adjusted for slope, erosion, flooding, and surface texture according to the II. Soils EFOTG

^b Soils in the southern region were not rated for oats and are shown with a zero "0".

^c Soils in the northern region or in both regions were not rated for grain sorghum and are shown with a zero "0".

^e Soils in the well drained group were not rated for grass-legume and are shown with a zero "0".

*n: The aggregation method is "Weighted Average using all components"