

# Soils Map

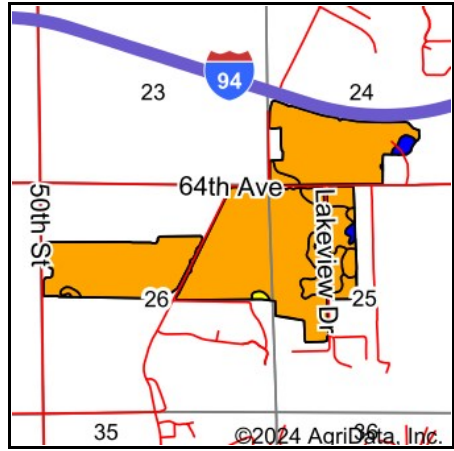

State: **Michigan**  
 County: **Van Buren**  
 Location: **26-3S-15W**  
 Township: **Lawrence**  
 Acres: **415.93**  
 Date: **5/17/2024**

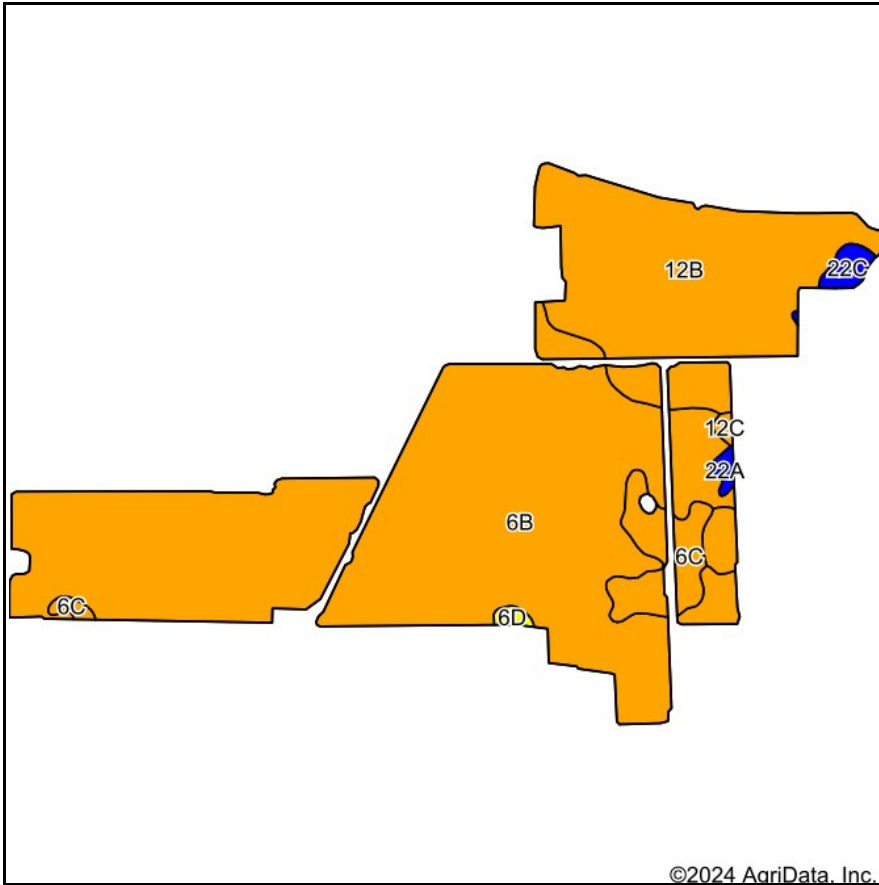

Maps Provided By:



© AgriData, Inc. 2023

www.AgriDataInc.com



Soils data provided by USDA and NRCS.

Area Symbol: MI159, Soil Area Version: 19

Code	Soil Description	Acres	Percent of field	Non-Irr Class Legend	Non-Irr Class *c	Irr Class *c	Corn Bu	Corn silage Tons	Soybeans Bu	*n NCCPI Corn	*n NCCPI Soybeans
6B	Oshtemo sandy loam, 0 to 6 percent slopes	280.47	67.5%		III s	III s				64	42
12B	Spinks-Oshtemo complex, 0 to 6 percent slopes	105.21	25.3%		III s	III s				56	34
6C	Oshtemo sandy loam, 6 to 12 percent slopes	18.41	4.4%		III e	III e				62	41
20B	Spinks loamy sand, 0 to 6 percent slopes	4.32	1.0%		III s	III s				53	31
22C	Kalamazoo loam, 6 to 12 percent slopes	3.65	0.9%		II e	II e				65	45
22A	Kalamazoo loam, 0 to 2 percent slopes	1.54	0.4%		II s	II s				67	47
6D	Oshtemo-Coloma loamy sands, 12 to 18 percent slopes	1.32	0.3%		IV e		80	13	21	51	35
12C	Spinks-Oshtemo complex, 6 to 12 percent slopes	1.01	0.2%		III e	III e				54	33
<b>Weighted Average</b>					<b>2.99</b>	<b>*-</b>	<b>0.3</b>	<b>*-</b>	<b>0.1</b>	<b>*n 61.7</b>	<b>*n 39.8</b>

Soils data provided by USDA and NRCS.

The aggregation method is "Weighted Average using all components"

\*c: Using Capabilities Class Dominant Condition Aggregation Method

\*- Irr Class weighted average cannot be calculated on the current soils data due to missing data.