

Soil Map

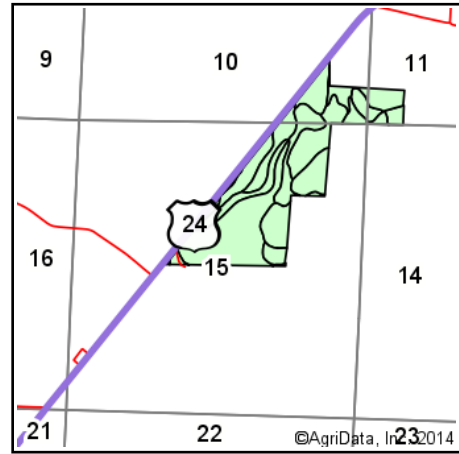

State: **Illinois**
 County: **Fulton**
 Location: **15-6N-5E**
 Township: **Banner**
 Acres: **128.3**
 Date: **12/23/2014**

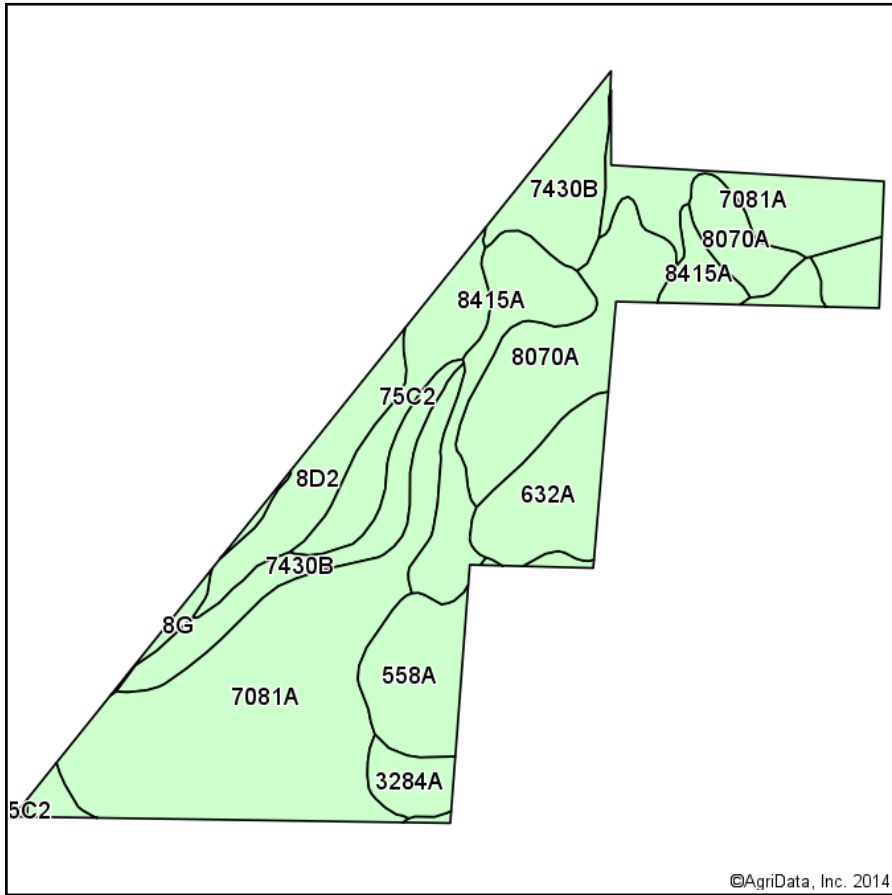
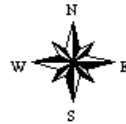

Maps Provided By:

 CUSTOMIZED ONLINE MAPPING
 © AgriData, Inc. 2014 www.AgriDataInc.com

Soils data provided by USDA and NRCS.

©AgriData, Inc. 2014

Area Symbol: IL057, Soil Area Version: 9

Code	Soil Description	Acres	Percent of field	Il. State Productivity Index Legend	Water Table	Restrictive Layer	Soil Drainage	Subsoil rooting a	Corn Bu/A	Soybeans Bu/A	Wheat Bu/A	Oats Bu/A b	Sorghum c Bu/A	Alfalfa d hay, T/A	Grass-leg e hay, T/A	Crop productivity index for optimum managemen
7081A	Littleton silt loam, 0 to 2 percent slopes, rarely flooded	44.85	35.0%		1.5ft.	> 6.5ft.	Somewhat poorly drained	FAV	194	61	74	100	0	0.00	6.02	
8070A	Beaucoup silty clay loam, 0 to 2 percent slopes, occasionally flooded	17.20	13.4%		0.5ft.	> 6.5ft.	Poorly drained	FAV	176	58	69	90	0	0.00	5.39	
7430B	Raddle silt loam, 2 to 5 percent slopes, rarely flooded	13.98	10.9%		> 6.5ft.	> 6.5ft.	Well drained	FAV	189	59	73	97	0	6.52	0.00	
8415A	Orion silt loam, 0 to 2 percent slopes, occasionally flooded	11.68	9.1%		1.5ft.	> 6.5ft.	Somewhat poorly drained	FAV	180	57	66	89	0	0.00	5.02	
558A	Breeds silty clay loam, 0 to 2 percent slopes	10.77	8.4%		1.5ft.	3.8ft. (Paralithic bedrock)	Somewhat poorly drained	FAV	159	52	63	82	0	4.77	0.00	
632A	Copperas, silty clay loam, 0 to 2 percent slopes	9.46	7.4%		0.5ft.	4.5ft. (Paralithic bedrock)	Poorly drained	FAV	163	53	63	78	0	0.00	5.14	



**75C2	Drury silt loam, 5 to 10 percent slopes, eroded	7.95	6.2%		> 6.5ft.	> 6.5ft.	Well drained	FAV	**161	**50	**63	**79	0	**5.37	0.00	*
**8D2	Hickory silt loam, 10 to 18 percent slopes, eroded	7.26	5.7%		> 6.5ft.	> 6.5ft.	Well drained	FAV	**108	**36	**44	**50	0	**3.58	0.00	
3284A	Tice silty clay loam, 0 to 2 percent slopes, frequently flooded	2.94	2.3%		1.5ft.	> 6.5ft.	Somewhat poorly drained	FAV	184	57	70	95	0	0.00	5.64	
3415A	Orion silt loam, 0 to 2 percent slopes, frequently flooded	1.22	1.0%		1.5ft.	> 6.5ft.	Somewhat poorly drained	FAV	180	57	66	89	0	0.00	5.02	
**8G	Hickory silt loam, 35 to 60 percent slopes	0.99	0.8%		> 6.5ft.	> 6.5ft.	Well drained	FAV	**58	**20	**24	**27	0	**1.93	0.00	
Weighted Average									176.2	56.1	67.8	89.3	*	1.66	3.84	1

Area Symbol: IL057, Soil Area Version: 9

Table: Optimum Crop Productivity Ratings for Illinois Soil by K.R. Olson and J.M. Lang, Office of Research, ACES, University of Illinois at Champaign-Urbana. Version: 1/2/2012 Amended Table S2 B811 (Updated 1/10/2012)

Crop yields and productivity indices for optimum management (B811) are maintained at the following NRES web site: <http://soilproductivity.nres.illinois.edu/>

** Indexes adjusted for slope and erosion according to Bulletin 811 Table S3

a UNF = unfavorable; FAV = favorable

b Soils in the southern region were not rated for oats and are shown with a zero "0".

c Soils in the northern region or in both regions were not rated for grain sorghum and are shown with a zero "0".

d Soils in the poorly drained group were not rated for alfalfa and are shown with a zero "0".

e Soils in the well drained group were not rated for grass-legume and are shown with a zero "0".

Field borders provided by Farm Service Agency as of 5/21/2008. Aerial photography provided by Aerial Photography Field Office.