

# Soils Map

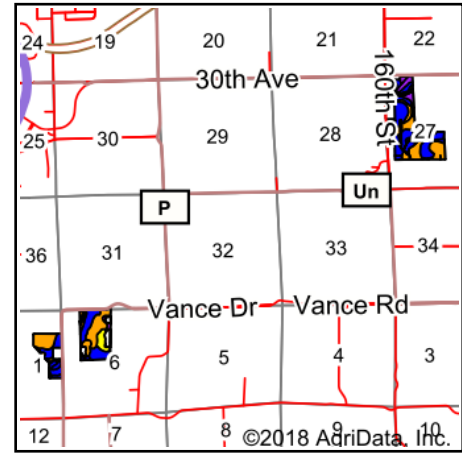

State: **Wisconsin**  
 County: **Chippewa**  
 Location: **32-28N-8W**  
 Township: **Hallie**  
 Acres: **223.55**  
 Date: **4/9/2018**



Area Symbol: WI017, Soil Area Version: 13  
 Area Symbol: WI035, Soil Area Version: 14

Code	Soil Description	Acres	Percent of field	Non-Irr Class Legend	Non-Irr Class *c	Cor n	Soybeans
MeB	Meridian loam, 2 to 6 percent slopes	25.27	11.3%		Ile	100	33
HnC2	Hixton loam, 6 to 12 percent slopes, eroded	20.85	9.3%		IIIe	80	26
BmA	Billett sandy loam, moderately well drained, 0 to 3 percent slopes	20.13	9.0%		IIIs	95	31
MeC2	Meridian loam, 6 to 12 percent slopes, eroded	18.46	8.3%		IIIe	90	30
AsB	Arland loam, 2 to 6 percent slopes	15.44	6.9%		Ile	90	30
SaB	Santiago silt loam, 2 to 6 percent slopes	13.64	6.1%		Ile	90	30
MrB	Merrillan sandy loam, 1 to 6 percent slopes	12.47	5.6%		IIIe	65	21
So	Shiffer loam, 0 to 2 percent slopes	11.75	5.3%		IIw	105	35
KeA	Kert loam, 0 to 3 percent slopes	10.34	4.6%		IIw	75	25
EID2	Eleva sandy loam, 12 to 20 percent slopes, eroded	9.44	4.2%		IVe	65	21
KeB	Kert silt loam, 1 to 6 percent slopes	8.47	3.8%		Ile	75	25
MeA	Meridian loam, 0 to 2 percent slopes	8.36	3.7%		IIs	100	33
Ve	Vesper silt loam, 0 to 2 percent slopes	6.66	3.0%		VIw		
MmA	Meridian loam, moderately well drained, 0 to 3 percent slopes	5.74	2.6%		IIs	105	35
ApC2	Arland sandy loam, 6 to 12 percent slopes, eroded	5.72	2.6%		IIIe	70	23
EIB	Eleva sandy loam, 2 to 6 percent slopes	5.50	2.5%		IIIs	85	28
MkC	Menahga loamy sand, 6 to 12 percent slopes	4.80	2.1%		VIIs	45	15
ApB	Arland sandy loam, 2 to 6 percent slopes	4.50	2.0%		Ile	80	26
HnB	Hixton loam, 2 to 6 percent slopes	3.73	1.7%		Ile	90	30
FnB	Freeon silt loam, 2 to 6 percent slopes	3.50	1.6%		Ile		
EmD2	Elk mound loam, 12 to 20 percent slopes, moderately eroded	2.48	1.1%		VIIs		
BIC2	Billett sandy loam, 6 to 12 percent slopes, eroded	1.76	0.8%		IIIe	80	26
So	Shiffer loam	1.63	0.7%		IIw	105	35
GaB	Gale silt loam, 2 to 6 percent slopes	1.43	0.6%		Ile	105	35



BIB	Billett sandy loam, 2 to 6 percent slopes	0.45	0.2%		IIIs	90	30
BoE	Boone-Plainbo complex, 12 to 45 percent slopes	0.43	0.2%		VIIIs		
HeC2	Hiles silt loam, 6 to 12 percent slopes, eroded	0.41	0.2%		IIIe	75	25
Af	Alluvial land, wet	0.13	0.1%		VIw		
HnC2	Hixton loam, 6 to 12 percent slopes, eroded	0.06	0.0%		IIIe	80	26
<b>Weighted Average</b>						<b>81.5</b>	<b>26.9</b>

\*c: Using Capabilities Class Dominant Condition Aggregation Method

Soils data provided by USDA and NRCS.